



WATCH NOW  
on YouTube!



Handle for easy carrying

Soft protective cover with  
hook-and-loop fastener



1

Lift the protective cover.

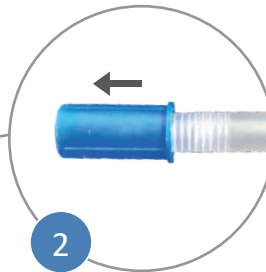

2

Open the valve by pulling the blue lock and wait approx. 30 seconds, until the air-cells have inflated automatically.

*(Valve lock can not fall off.)*

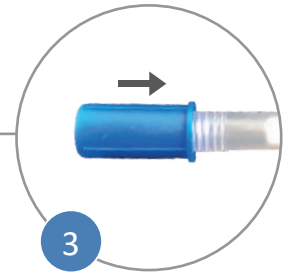

3

Close the valve by pressing.



4

Put the cushion on the wheelchair or seat.

*(The handle must point to the front and the attached arrows must point upwards.)*

Sit on the cushion.

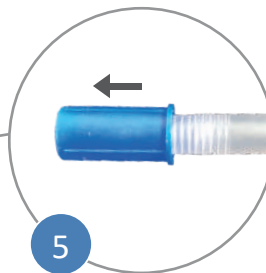

5

Carefully open the valve again until the ideal sitting comfort is achieved.

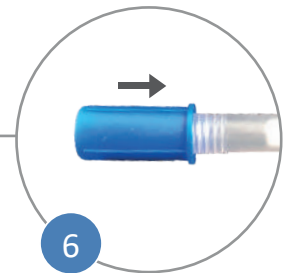

6

Close the valve and the protective cover.